

Greek words (forms) translated "Temple" in the English N.T.

1. ιερον (*hieron*)

a place consecrated or sacred as given or devoted to God, a place that subserves a sacred purpose, as the Temple, as the sacred things themselves; (e.g. *τα ιερα* are the sacrifices; *ιερευς* is the person who offers them; *το ιερον* is the place where they are offered). *ιερον* is used of the whole compass of the sacred enclosure, including the outer courts, porches and all other subordinate buildings appertaining to the Temple. (*This word must be carefully distinguished in every passage from No. 2*)

2. ναοσ (*naos*)

dwelling, habitation of God; the interior and most sacred part of No.1, where the presence of God was manifested; the holy place, the Holy of Holies.

3. οικος (*oikos*)

house: occurs in Lu 11:51 (translated Temple). The whole "saying" is a reference to 2 Chron 24:18-22, verse 19 being amplified to show the purpose and counsel of God in the historical notice of the facts.

There are seven buildings mentioned in Scripture:

1. *The Mosaic Tabernacle* (translated temple, 1 Sam 1:9, 3:3), lasted 500 years and was superceded by
2. *Solomon's Temple*, 1 Ki 6:7; lasted 400 years and was destroyed by Nebuchadnezzar.
3. *Zerababel's Temple*, Ezra 4: 1, 2; lasted 500 years and was destroyed by Antiochus Epiphanes.
4. *Herod's temple*, John 2:9; 46 years in the building, lasted 85 years, destroyed by Titus.
5. *The Temple of God*, 2 Thes 2:4; (Holy of Holies, *Gr. naos*) yet to be built and indwelt by, "the man of sin", the anti-Christ.
6. *The Millenial Temple*, Ezek 41-44.
7. *The Heavenly Temple*, Rev 21:3, 22.

From: (*A Critical Lexicon and Concordance to the English and Greek New Testament. E.W Bullinger*)

And let them make me a sanctuary; that I may **dwell** among them. According to all that I shew thee, after the pattern of the tabernacle, and the pattern of all the instruments thereof, even so shall ye make it. (Ex 25:8,9)



Replica of the tabernacle in the wilderness.



Model of Herod's Temple in the Israel Museum

THE TEMPLE OF SOLOMON
and the
Royal Buildings on Mount Moriah
on the present
HARAM AREA

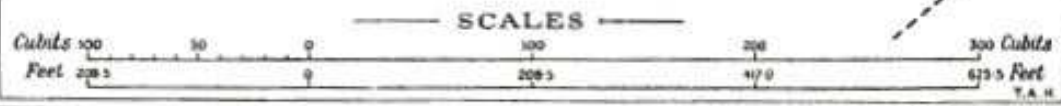
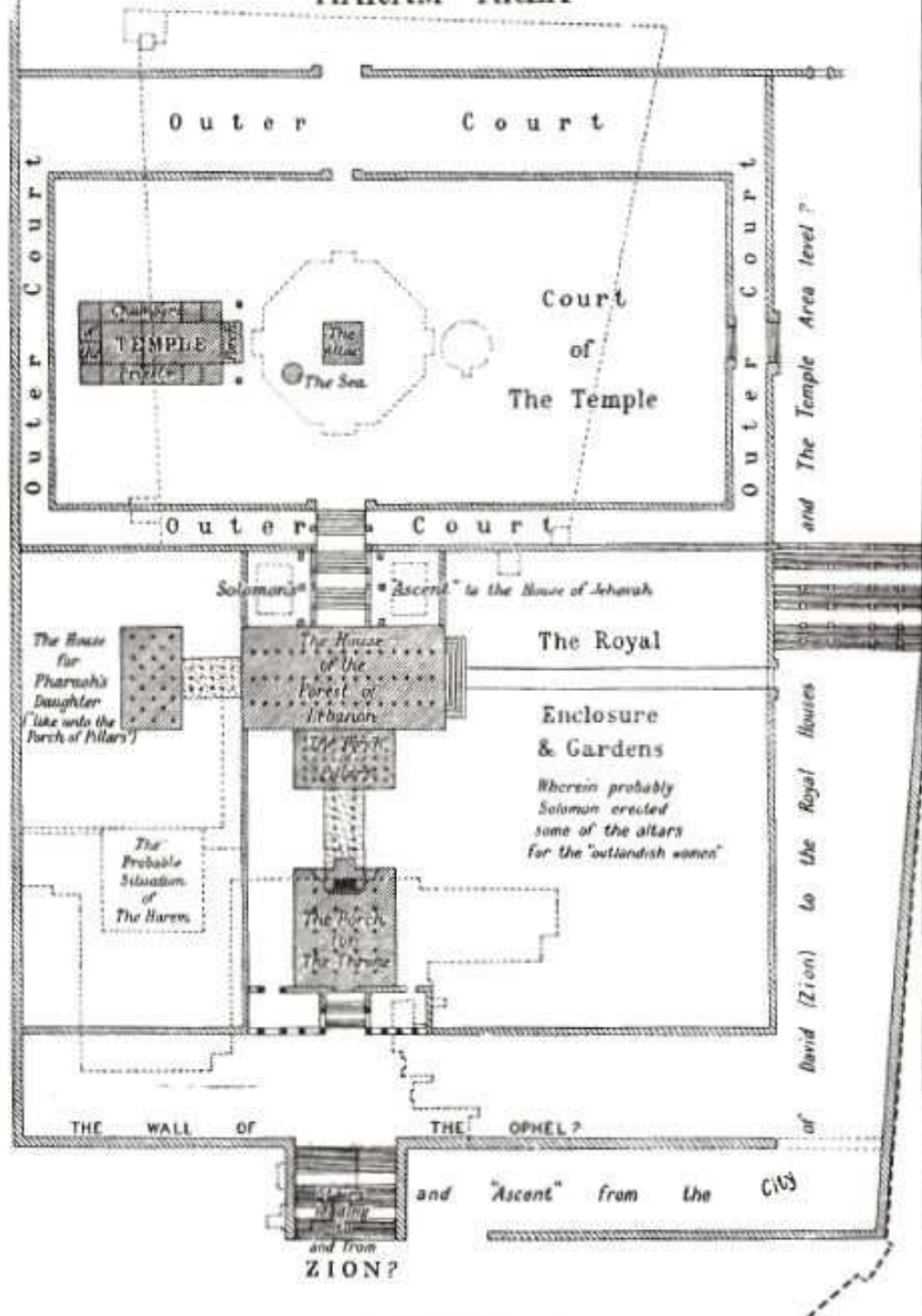

Stanford's Eng'g Estab' London